

ABCO Bead COMPONENTS

## EDMC100505-FY1 Series



5448-4, Sangdaewon-dong, Jungwon-gu,  
Seongnam-si, Gyeonggi-do, KOREA

Sales Dept. TEL:82-31-730-5082

FAX:82-31-730-5152

Eng. Dept. TEL:82-31-730-5053

FAX:82-31-730-5153

---

ABCO ELECTRONICS CO., LTD.

# EDMC100505-FY1 Series



<http://www.abco.co.kr>

## ▣ Features

1. This specification applies to MULTILAYER FERRITE CHIP BEADS
2. Operating temperature -55°C ~ +125°C. (Including self - temperature rise)

## ▣ Ordering Code

<b>EDMC</b>	<b>100505</b>	<b>T</b>	<b>-</b>	<b>221</b>	<b>Y</b>	<b>-</b>	<b>FY1</b>
①	②	③		④	⑤		⑥

① Type	
EDMC	

② Dimensions(mm)
100505 : 1.0(L) × 0.5(W) × 0.5(T)

③ Packing	
T	TAPING

④ Impedance(Ω)	
221	220
102	1000

⑤ Tolerance
Y : ±25%

⑥ Internal Code
FY1

# EDMC100505-FY1 Series



<http://www.abco.co.kr>

## Shapes and Dimensions

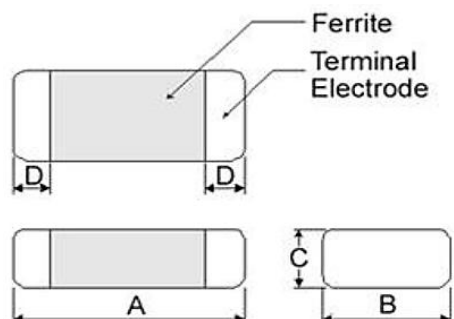

## Recommended PC Board Pattern

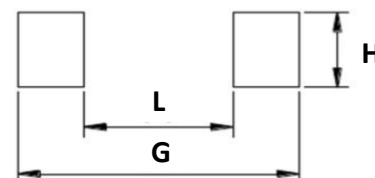

Series	A(mm)	B(mm)	C(mm)	D(mm)
EDMC100505-FY1	1.0±0.10	0.50±0.10	0.50±0.10	0.25±0.10

L(mm)	G(mm)	H(mm)
0.4	1.2~1.4	0.5

## Electrical Characteristics

Part Number	Impedance ( $\Omega \pm 25\%$ )	Test Freq. (MHz)	Impedance ( $\Omega \pm 40\%$ )	Test Freq. (MHz)	RDC ( $\Omega$ ) Max.	Rated Current(mA)
						$\Delta T = 30^\circ\text{C}$ Max.
EDMC100505T-221Y-FY1	220	100	270	1000	0.55	450
EDMC100505T-301Y-FY1	300	100	450	1000	0.55	350
EDMC100505T-471Y-FY1	470	100	650	1000	0.60	300
EDMC100505T-601Y-FY1	600	100	1000	1000	0.70	300
EDMC100505T-102Y-FY1	1000	100	1400	1000	1.10	250

### 1. Testing Instrument

- Impedance : HP4291A
- RDC :HP4338B or CHEN HWA 502

2. Rate Current : Applied the current to coils, the temperature rise shall not be more than 30°C

# EDMC100505-FY1 Series



<http://www.abco.co.kr>

## Graph

