

ABCO Bead COMPONENTS

## EDMC100505-UP Series



5448-4, Sangdaewon-dong, Jungwon-gu,  
Seongnam-si, Gyeonggi-do, KOREA

Sales Dept. TEL:82-31-730-5082

FAX:82-31-730-5152

Eng. Dept. TEL:82-31-730-5053

FAX:82-31-730-5153

---

ABCO ELECTRONICS CO., LTD.

# EDMC100505-UP Series



<http://www.abco.co.kr>

## ▣ Features

1. This specification applies to MULTILAYER FERRITE CHIP BEADS
2. Operating temperature -55°C ~ +125°C. (Including self - temperature rise)

## ▣ Ordering Code

<b>EDMC</b>	<b>100505</b>	<b>T</b>	<b>-</b>	<b>300</b>	<b>Y</b>	<b>-</b>	<b>UP</b>
①	②	③		④	⑤		⑥

① Type	
EDMC	

② Dimensions(mm)
100505 : 1.0(L) × 0.5(W) × 0.5(T)

③ Packing	
T	TAPING

④ Impedance(Ω)	
300	30
121	120

⑤ Tolerance
Y : ±25%

⑥ Internal Code
UP

# EDMC100505-UP Series



<http://www.abco.co.kr>

## ■ Shapes and Dimensions

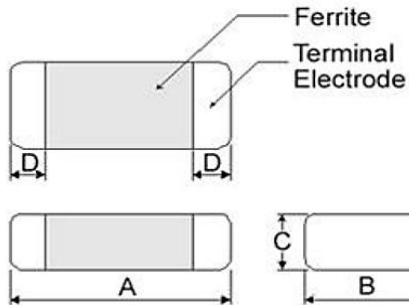

## ■ Recommended PC Board Pattern

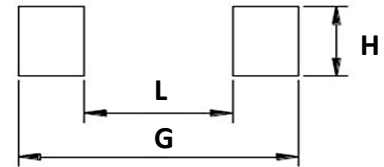

Series	A(mm)	B(mm)	C(mm)	D(mm)
EDMC100505-UP	1.0±0.10	0.50±0.10	0.5±0.10	0.25±0.10

L(mm)	G(mm)	H(mm)
0.4	1.2~1.4	0.5

## ■ Electrical Characteristics

Part Number	Impedance ( $\Omega \pm 25\%$ )	Test Frequency (MHz)	RDC ( $\Omega$ ) Max.	Rated Current(mA)
				$\Delta T = 30^\circ\text{C}$ Max.
EDMC100505T-300Y-UP	30	100	0.022	3000
EDMC100505T-330Y-UP	33	100	0.022	3000
EDMC100505T-600Y-UP	60	100	0.032	2500
EDMC100505T-800Y-UP	80	100	0.038	2300
EDMC100505T-121Y-UP	120	100	0.055	2000
EDMC100505T-181Y-UP	180	100	0.090	1500
EDMC100505T-221Y-UP	220	100	0.100	1400
EDMC100505T-331Y-UP	330	100	0.150	1200
EDMC100505T-471Y-UP	470	100	0.200	1000

### 1. Testing Instrument

- Impedance : HP4291A
- RDC :HP4338B or CHEN HWA 502

### 2. Rate Current : Applied the current to coils, the temperature rise shall not be more than 30°C

# EDMC100505-UP Series



<http://www.abco.co.kr>

## Graph

