

ABCO Standard Inductor

**AEC-Q200**

# POWER INDUCTOR

## LPMT5030-A4 series

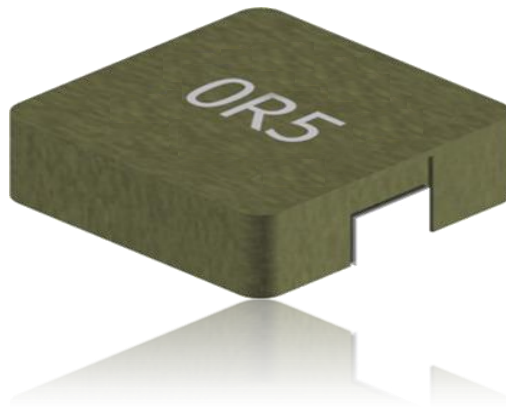

31, Dunchon-daero 388 Beon-gil  
Seongnam-si, Gyeonggi-do, KOREA  
Sales Dept. TEL:82-31-730-5082  
FAX:82-31-730-5152  
Eng. Dept. TEL:82-31-730-5053  
FAX:82-31-730-5153

---

ABCO ELECTRONICS CO., LTD.

■ **OPERATION TEMP.**

LPMT5030-A4 series : -55°C~+155°C(Including self-generated heat)

■ **FEATURES**

- Metal molding Construction
- High Current and Low Resistance

■ **APPLICATIONS**

DC/DC converters for PDA, Notebook, Desktop, Battery powered devices etc.

■ **ORDERING CODE**

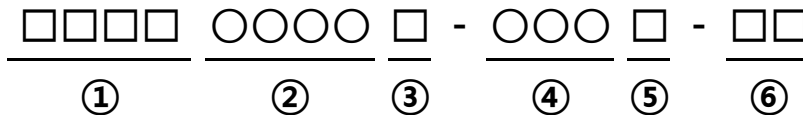

|              |  |
|--------------|--|
| <b>①Type</b> |  |
| LPMT         |  |

|                          |                |
|--------------------------|----------------|
| <b>②Body size(LxWxH)</b> |                |
| 5030                     | 5.70X5.20X2.80 |

|                 |        |
|-----------------|--------|
| <b>③Packing</b> |        |
| T               | TAPING |
| B               | BULK   |

|                          |       |
|--------------------------|-------|
| <b>④Inductance Value</b> |       |
| R10                      | 0.1μH |
| 1R0                      | 1.0μH |
| 100                      | 10μH  |

|                        |      |
|------------------------|------|
| <b>⑤Inductance Tol</b> |      |
| M                      | ±20% |

|                       |  |
|-----------------------|--|
| <b>⑥Internal Code</b> |  |
| A4                    |  |

LPMT5030-A4 SERIES

■ SHAPE & DIMENSIONS / RECOMMENDED SOLDER LAND PATTERN

Unit:mm

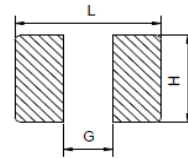
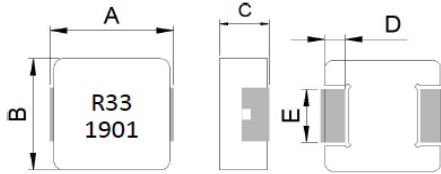

| Series      | A(mm)   | B(mm)   | C(mm)   | D(mm)   | E(mm)   |
|-------------|---------|---------|---------|---------|---------|
| LPMT5030-A4 | 5.7±0.3 | 5.2±0.2 | 2.8±0.2 | 1.0±0.3 | 2.0±0.2 |

| L(mm) | G(mm) | H(mm) |
|-------|-------|-------|
| 6.0   | 2.8   | 2.5   |

■ ELECTRICAL CHARACTERISTICS

| Ordering code       | Inductance<br>[μH] | Tolerance<br>(%) | Freq.<br>(kHz) | Rdc(mΩ) |      | Isat(A) | Irms(A) |
|---------------------|--------------------|------------------|----------------|---------|------|---------|---------|
|                     |                    |                  |                | Max.    | Typ. | Typ.    | Typ.    |
| LPMT5030T - R47M-A4 | 0.47               | ± 20             | 100            | 6.0     | 5.2  | 10.0    | 13.5    |
| LPMT5030T - R68M-A4 | 0.68               | ± 20             |                | 8.5     | 7.4  | 9.0     | 12.5    |
| LPMT5030T - R82M-A4 | 0.82               | ± 20             |                | 9.2     | 8.0  | 8.8     | 10.0    |
| LPMT5030T - 1R0M-A4 | 1.00               | ± 20             |                | 12.0    | 10.5 | 8.5     | 9.0     |
| LPMT5030T - 1R5M-A4 | 1.50               | ± 20             |                | 15.7    | 13.6 | 7.5     | 8.0     |
| LPMT5030T - 2R2M-A4 | 2.20               | ± 20             |                | 25.0    | 21.6 | 6.5     | 7.0     |
| LPMT5030T - 3R3M-A4 | 3.30               | ± 20             |                | 33.0    | 28.0 | 6.0     | 6.3     |
| LPMT5030T - 4R7M-A4 | 4.70               | ± 20             |                | 44.0    | 38.0 | 5.3     | 5.5     |
| LPMT5030T - 5R6M-A4 | 5.60               | ± 20             |                | 58.0    | 50.0 | 4.6     | 5.0     |
| LPMT5030T - 6R8M-A4 | 6.80               | ± 20             |                | 66.0    | 57.0 | 3.5     | 4.3     |
| LPMT5030T - 100M-A4 | 10.0               | ± 20             |                | 103     | 88.0 | 2.5     | 3.8     |

▼ Test Equipments

- Inductance measured : HP4284A,CH11025,CH3302,CH1320,CH1320S LCR METER(100kHz, 1.0V)
- Rdc : CH16502,Agilent33420A MICRO OHMMETER.
- Saturation Current (Isat) will cause L0 to drop approximately 30%.
- Heat Rated Current (Irms) will cause the coil temperature rise approximately ΔT of 40°C
- ※ Rated DC current(I<sub>dc</sub>) : The value of Isat or Irms , whichever is smaller

▼ Operating Temperature Range

-55°C ~ +155°C (Including self-generated heat)